

Horizontal Grill
mod GHPI **R4/1700 Multifunction**

Dimensions:

1703mm (w) x 966mm (h) x 833mm (p)

Weight: 320 kg

Thermal Flow: 50,4 kw

Type: A

Category: II_{2H3+}

Voltage: 230V

Electric Power: 130 W

Butane gas

Pressure - 28-30 mbar

Consumption - 3,9 kg/h

Propane gas

Pressure - 37 mbar

Consumption - 3,9 kg/h

Natural gas

Pressure - 20 mbar

Consumption - 5,3 m³/h



scraper



suporte do extremo



GRE.R1.C20
dividing plate



GRE.R1.P10
coverage



RE.R1.U10
support for two
gas bottles



GRE.R1.H20
half support for rotating grid



GRE.R1.H10
support for rotating grid



GRE.R1.J10
double grid



GRE.R1.L10
drum



GRE.R1.G10
half grid



GRE.R1.K10
grid for rib



GRE.R4.P10
pork roasting spit



GRE.R4.M10
meat spit



GRE.R1.M20
half meat
spit



GRE.R1.T10
half pork
roasting spit



GRE.R1.C22
half spit
support



GRE.R1.V10
module rotation

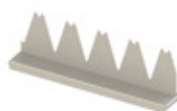

GRE.R1.V20
spit support front



GRE.R1.V40
mini double spit



GRE.R1.V30
mini meat spit

Mega
Mega

CE 0464

GRESILVA[®]
a new grilling
concept

Horizontal Grill
mod GHPI **R4/1700 Multifunction**

